

SEE SHEET G102 FOR  
CONVEYANCE SYSTEM INDEX

**LEGEND**

EXISTING FEATURES		EXISTING FEATURES		PROPOSED FEATURES	
---	PROPERTY LINE	○	UTILITY POLE	—MH3—	SANITARY SEWER W/ WELL HEAD PROTECTION
●	SUBJECT PROPERTY CORNER	⊗	STREET LIGHT	270	FINISH GROUND CONTOUR
○	SURVEY MARKER FOUND	⊕	STREET SIGN	×270	SPOT ELEVATION
---	LEGAL R/W LINE	⊖	BUSINESS SIGN	---	EDGE OF PAVEMENT
---	PERPETUAL SANITARY SEWER EASEMENT	⊙	WELL	---	FENCE
---	TEMPORARY CONSTRUCTION EASEMENT	—ST—	STORM SEWER/CB	---	CONCRETE MONUMENT TO BE SET
---	BUILDING SETBACK LINE	TEL	TELEPHONE (BURIED)/MH	---	IRON PIN TO BE SET
---	CURB	W	WATER LINE/VALVE	---	PERCOLATION TEST SITE
---	EDGE OF PAVEMENT	OV	GAS LINE/VALVE	---	EASEMENT
---	EDGE OF SHOULDER	O/E	OVERHEAD WIRES	---	SANITARY SEWER EASEMENT DRAWING NO.
---	PAVED DRIVEWAY	U/E	UNDERGROUND CONDUIT	E60	OVERLAY
---	GRAVEL DRIVEWAY	---	SIDEWALK	---	PROPOSED TREE LINE
---	1 FT. CONTOUR	---	DELINEATED WETLANDS/WETLAND IMPACT AREA	---	PROPOSED FEATURE
---	5 FT. CONTOUR	---	FINISHED/GROUND FLOOR - RIGHT	---	
---	SPOT ELEVATION	---	FINISHED/GROUND FLOOR - LEFT	---	
---	GUIDE RAIL	---	EXISTING FEATURE	---	
---	FENCE	---		---	
---	STREAM WATERS OF THE U.S. - ORDINARY HIGH WATER LINE	---		---	
---	100-YEAR FLOODPLAIN BNDY.	---		---	
---	FLOODWAY BNDY.	---		---	
---	SOIL LINE	---		---	
---	TREE AND SHRUB LINE	---		---	
---	TREE	---		---	

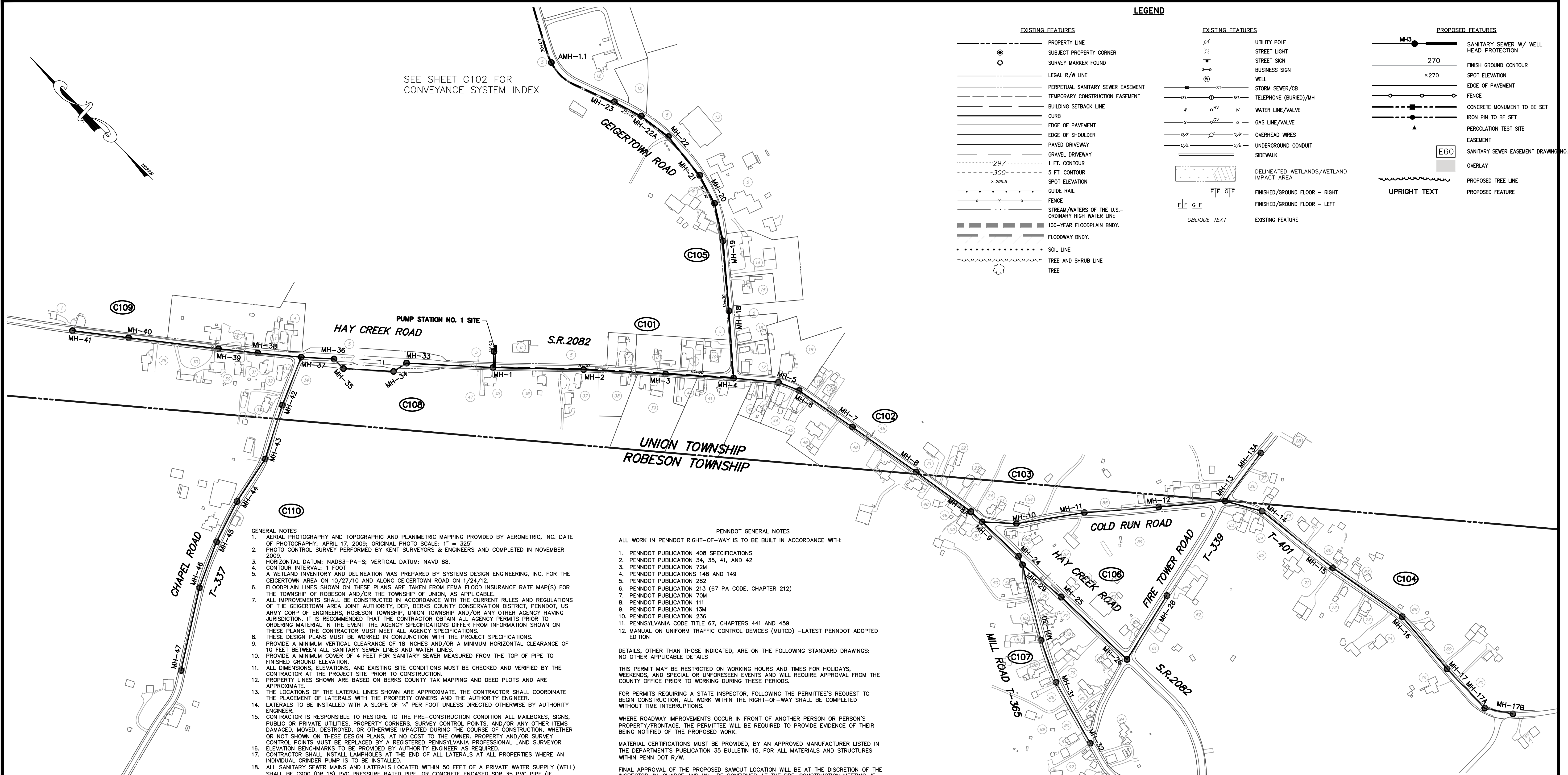

- GENERAL NOTES**
- AERIAL PHOTOGRAPHY AND TOPOGRAPHIC AND PLANIMETRIC MAPPING PROVIDED BY AEROMETRIC, INC. DATE OF PHOTOGRAPHY: APRIL 17, 2009; ORIGINAL PHOTO SCALE: 1" = 325'
  - PHOTO CONTROL SURVEY PERFORMED BY KENT SURVEYORS & ENGINEERS AND COMPLETED IN NOVEMBER 2009.
  - HORIZONTAL DATUM: NAD83-PA-S; VERTICAL DATUM: NAVD 88.
  - CONTOUR INTERVAL: 1 FOOT
  - A WETLAND INVENTORY AND DELINEATION WAS PREPARED BY SYSTEMS DESIGN ENGINEERING, INC. FOR THE GEIGERTOWN AREA ON 10/27/10 AND ALONG GEIGERTOWN ROAD ON 1/24/12.
  - FLOODPLAIN LINES SHOWN ON THESE PLANS ARE TAKEN FROM FEMA FLOOD INSURANCE RATE MAP(S) FOR THE TOWNSHIP OF ROBESON AND/OR THE TOWNSHIP OF UNION, AS APPLICABLE.
  - ALL IMPROVEMENTS SHALL BE CONSTRUCTED IN ACCORDANCE WITH THE CURRENT RULES AND REGULATIONS OF THE GEIGERTOWN AREA JOINT AUTHORITY, DEP. BERKS COUNTY CONSERVATION DISTRICT, PENNDOT, US ARMY CORP OF ENGINEERS, ROBESON TOWNSHIP, UNION TOWNSHIP AND/OR ANY OTHER AGENCY HAVING JURISDICTION. IT IS RECOMMENDED THAT THE CONTRACTOR OBTAIN ALL AGENCY PERMITS PRIOR TO ORDERING MATERIAL IN THE EVENT THE AGENCY SPECIFICATIONS DIFFER FROM INFORMATION SHOWN ON THESE PLANS. THE CONTRACTOR MUST MEET ALL AGENCY SPECIFICATIONS.
  - THESE DESIGN PLANS MUST BE WORKED IN CONJUNCTION WITH THE PROJECT SPECIFICATIONS.
  - PROVIDE A MINIMUM VERTICAL CLEARANCE OF 18 INCHES AND/OR A MINIMUM HORIZONTAL CLEARANCE OF 10 FEET BETWEEN ALL SANITARY SEWER LINES AND WATER LINES.
  - PROVIDE A MINIMUM COVER OF 4 FEET FOR SANITARY SEWER MEASURED FROM THE TOP OF PIPE TO FINISHED GROUND ELEVATION.
  - ALL DIMENSIONS, ELEVATIONS, AND EXISTING SITE CONDITIONS MUST BE CHECKED AND VERIFIED BY THE CONTRACTOR AT THE PROJECT SITE PRIOR TO CONSTRUCTION.
  - PROPERTY LINES SHOWN ARE BASED ON BERKS COUNTY TAX MAPPING AND DEED PLOTS AND ARE APPROXIMATE.
  - THE LOCATIONS OF THE LATERAL LINES SHOWN ARE APPROXIMATE. THE CONTRACTOR SHALL COORDINATE THE PLACEMENT OF LATERALS WITH THE PROPERTY OWNERS AND THE AUTHORITY ENGINEER.
  - LATERALS TO BE INSTALLED WITH A SLOPE OF 1/4" PER FOOT UNLESS DIRECTED OTHERWISE BY AUTHORITY ENGINEER.
  - CONTRACTOR IS RESPONSIBLE TO RESTORE TO THE PRE-CONSTRUCTION CONDITION ALL MAILBOXES, SIGNS, PUBLIC OR PRIVATE UTILITIES, PROPERTY CORNERS, SURVEY CONTROL POINTS, AND/OR ANY OTHER ITEMS DAMAGED, MOVED, DESTROYED, OR OTHERWISE IMPACTED DURING THE COURSE OF CONSTRUCTION, WHETHER OR NOT SHOWN ON THESE DESIGN PLANS, AT NO COST TO THE OWNER. PROPERTY AND/OR SURVEY CONTROL POINTS MUST BE REPLACED BY A REGISTERED PENNSYLVANIA PROFESSIONAL LAND SURVEYOR. ELEVATION BENCHMARKS TO BE PROVIDED BY AUTHORITY ENGINEER AS REQUIRED.
  - CONTRACTOR SHALL INSTALL LAMPHOLES AT THE END OF ALL LATERALS AT ALL PROPERTIES WHERE AN INDIVIDUAL GRINDER PUMP IS TO BE INSTALLED.
  - ALL SANITARY SEWER MAINS AND LATERALS LOCATED WITHIN 50 FEET OF A PRIVATE WATER SUPPLY (WELL) SHALL BE C900 (DR 18) PVC PRESSURE RATED PIPE, OR CONCRETE ENCASED SDR 35 PVC PIPE (IF AUTHORIZED BY THE AUTHORITY), TO PROVIDE FOR WELL ISOLATION PROTECTION.
  - THE PROPOSED SANITARY SEWER PIPE LENGTHS SHOWN ARE MEASURED FROM CENTER OF STRUCTURE TO CENTER OF STRUCTURE (SEE SECTION 02731.1-04).
  - CONTRACTOR IS RESPONSIBLE TO COORDINATE WITH PENNDOT ANY AND ALL CONTRACT WORK REQUIRED WITHIN EXISTING PENNDOT RIGHTS-OF-WAY.
  - CONTRACTOR IS RESPONSIBLE TO COORDINATE HIS WORK TO MAINTAIN/KEEP IN SERVICE ANY PRIVATE SANITARY SEWER SYSTEM AND/OR PUBLIC SANITARY SEWER SYSTEM ENCOUNTERED DURING THE PERFORMANCE OF CONTRACT WORK. ANY DAMAGE TO EXISTING SANITARY SEWER SYSTEMS SHALL BE IMMEDIATELY REPAIRED BY THE CONTRACTOR AT HIS EXPENSE, AND WORK SHALL BE COORDINATED WITH THE PROPERTY OWNER(S) OR SEWER AUTHORITY INVOLVED. NO INTERRUPTION OF ANY SANITARY SEWER SERVICE WILL BE PERMITTED UNLESS APPROVED BY THE GEIGERTOWN AREA JOINT AUTHORITY AND AUTHORITY ENGINEER.
  - ALL SANITARY SEWER PIPE AND LATERALS SHALL BE PVC SDR 35 UNLESS OTHERWISE NOTED. THERE ARE LOCATIONS THROUGHOUT THE SANITARY SEWER COLLECTION SYSTEM THAT ARE GREATER THAN 12 FEET IN DEPTH. THESE MAINLINE RUNS FROM MANHOLE TO MANHOLE SHALL BE CONSTRUCTED OF PVC SDR 26 PIPE, OR CLASS 52 DIP. ALL LATERALS CONNECTED TO THESE RUNS OF PVC SDR 26 MUST ALSO BE SDR 26 UNLESS SUCH LOCATION THAT SDR 35 PIPE CAN BE USED. THE APPROPRIATE FITTINGS BETWEEN THE SDR 35 AND SDR 26 PIPE (IF APPLICABLE) SHALL BE INCLUDED AS PART OF THE WORK BID.
  - ALL STRUCTURES AND MANHOLES LOCATED WITHIN PENNDOT R/W SHALL COMPLY WITH PENNDOT RC STANDARDS AND PENNDOT 408(LATEST EDITIONS). PENNDOT DETAILS WITHIN PENNDOT RIGHT-OF-WAY SHALL TAKE PREFERENCE OVER PLAN DETAILS IN THE EVENT OF A CONFLICT.

- PENNDOT GENERAL NOTES**
- ALL WORK IN PENNDOT RIGHT-OF-WAY IS TO BE BUILT IN ACCORDANCE WITH:
- PENNDOT PUBLICATION 408 SPECIFICATIONS
  - PENNDOT PUBLICATION 34, 35, 41, AND 42
  - PENNDOT PUBLICATION 72M
  - PENNDOT PUBLICATIONS 148 AND 149
  - PENNDOT PUBLICATION 282
  - PENNDOT PUBLICATION 213 (67 PA CODE, CHAPTER 212)
  - PENNDOT PUBLICATION 70M
  - PENNDOT PUBLICATION 111
  - PENNDOT PUBLICATION 13M
  - PENNDOT PUBLICATION 236
  - PENNSYLVANIA CODE TITLE 67, CHAPTERS 441 AND 459
  - MANUAL ON UNIFORM TRAFFIC CONTROL DEVICES (MUTCD) -LATEST PENNDOT ADOPTED EDITION

DETAILS, OTHER THAN THOSE INDICATED, ARE ON THE FOLLOWING STANDARD DRAWINGS:  
NO OTHER APPLICABLE DETAILS

THIS PERMIT MAY BE RESTRICTED ON WORKING HOURS AND TIMES FOR HOLIDAYS, WEEKENDS, AND SPECIAL OR UNFORESEEN EVENTS AND WILL REQUIRE APPROVAL FROM THE COUNTY OFFICE PRIOR TO WORKING DURING THESE PERIODS.

FOR PERMITS REQUIRING A STATE INSPECTOR, FOLLOWING THE PERMITEE'S REQUEST TO BEGIN CONSTRUCTION, ALL WORK WITHIN THE RIGHT-OF-WAY SHALL BE COMPLETED WITHOUT TIME INTERRUPTIONS.

WHERE ROADWAY IMPROVEMENTS OCCUR IN FRONT OF ANOTHER PERSON OR PERSON'S PROPERTY/FRONTAGE, THE PERMITEE WILL BE REQUIRED TO PROVIDE EVIDENCE OF THEIR BEING NOTIFIED OF THE PROPOSED WORK.

MATERIAL CERTIFICATIONS MUST BE PROVIDED, BY AN APPROVED MANUFACTURER LISTED IN THE DEPARTMENT'S PUBLICATION 35 BULLETIN 15, FOR ALL MATERIALS AND STRUCTURES WITHIN PENN DOT R/W.

FINAL APPROVAL OF THE PROPOSED SAWCUT LOCATION WILL BE AT THE DISCRETION OF THE INSPECTOR-IN-CHARGE AND WILL BE CONFIRMED AT THE PRE-CONSTRUCTION MEETING. IF THE SAWCUT MUST BE LOCATED WITHIN A TRAVEL LANE, IT WILL BE NECESSARY TO MILL AND OVERLAY THE TRAVEL LANE TO PREVENT A JOINT IN A WHEEL PATH.

MODIFICATIONS TO EXISTING DRAINAGE STRUCTURES MAY RESULT IN THE NEED TO REPLACE THE STRUCTURE. REPLACEMENT WILL BE AT THE DISCRETION OF THE INSPECTOR IN CHARGE.

CONTRACTOR WILL NOTIFY THE PENNDOT PRESS OFFICE AT 610-871-4555 A MINIMUM OF THREE WORKING DAYS PRIOR TO THE CLOSING OF TRAVEL LANE.

CONSTRUCT ALL PROPOSED PEDESTRIAN FACILITIES ON THESE PLANS TO COMPLY WITH THE AMERICANS WITH DISABILITIES ACT, PUBLIC RIGHT-OF-WAY ACCESSIBILITY GUIDELINES (PROWAG), AND THE ADA ACCESSIBILITY GUIDELINES (ADAAG).

ALL SLOPE MEASUREMENTS WILL BE INSPECTED / VERIFIED WITH A 2 FOOT SMART LEVEL.

PRIOR TO AN OVERLAY, BITUMINOUS OR CONCRETE BASE REPAIR OR JOINT REPLACEMENT MAYBE REQUIRED. REPAIR/REPLACEMENT WILL BE AT THE DISCRETION OF THE INSPECTOR IN CHARGE.

THREE WORKING DAYS PRIOR TO EXCAVATION, THE CONTRACTOR MUST CONTACT THE PA ONE CALL SYSTEM, INC., PHONE 1-800-242-1776

NO PARALLEL OPENING MAY BE MADE FOR MORE THAN 200 LINEAR FEET AT ONE TIME UNLESS AUTHORIZED BY THE HIGHWAY OCCUPANCY PERMIT. (67PA CODE, CHAPTER 459.8(C)(4))

CONTRACTOR SHALL BACKFILL IN ACCORDANCE WITH PENNDOT STANDARD SPECIFICATIONS AND DETAILS. (67 PA CODE, CHAPTER 459.8(G))

THE LEGAL RIGHT-OF-WAY LINE OF S.R. 2082, FORMERLY L.R. 328, FROM STA. 219+74.17 TO STA. 271+27 IS 33 FEET BASED ON THE ACT OF MAY 1, 1933, P.L. 103, SECTION 1105, AS AMENDED. THERE IS NO PUBLIC RECORD OF ANY OTHER WIDTH.

**INDEX MAP LEGEND**

- (C101) DENOTES PLAN AND PROFILE DWG. NO.
  - [E60] DENOTES SANITARY SEWER EASEMENT DWG. NO.
  - PROPOSED SANITARY SEWER MAIN AND MANHOLE
  - PROPOSED SANITARY SEWER FORCEMAIN
  - AMH--- PROPOSED SANITARY SEWER FORCEMAIN AIR RELEASE MANHOLE
  - DMH--- PROPOSED SANITARY SEWER FORCEMAIN DRAIN MANHOLE
- ALL SANITARY SEWER 8" PVC SDR35 UNLESS NOTED OTHERWISE

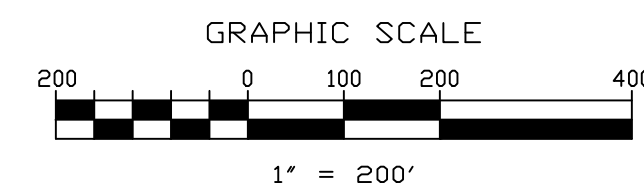

3	8/15/14	PENNDOT REVISIONS	MAK
2	6/24/14	PER DEP 5/15/14 GPs/11 REVIEW	MAK
1	6/02/14	REVISED FOR PENNDOT SUBMISSION	DRH
NO.	DATE	REVISION	BY

**Systems Design Engineering, Inc.**  
Engineers • Surveyors • Planners • Construction Managers  
1032 James Dr. Boyertown, PA 19389  
Leesport, PA 19533  
Phone: 610.916.8500  
Fax: 610.916.8501  
E-mail: sde@sdei.net www.sdei.net

**GEIGERTOWN AREA JOINT AUTHORITY**  
**GEIGERTOWN AREA SANITARY SEWER**  
**COLLECTION AND CONVEYANCE SYSTEM**  
**COLLECTION SYSTEM INDEX**

SITUATE IN  
ROBESON/UNION TOWNSHIPS BERKS COUNTY PENNSYLVANIA

DRAWN BY	CHECKED	APPROVED	CADD FILE NAME
JWS	KM	KRS	SHEETS-INDEX.dwg
DATE	SCALE	DRAWING NUMBER	
12/20/13	AS NOTED	D-13-1087-0202-G101	

Copyright 2014 Systems Design Engineering, Inc. - 1-Cadd Project\Robeson\Geigertown Sewer Systems\INDEX.dwg, September 15, 2014 3:32 pm by jmw